

## Measuring your existing cabinets for custom rolling shelves

Are you ready to update your existing cabinets in a few simple steps with Miracle Shelves? To get started grab your tape measure, pen and paper.

- Clear out your cabinet.
- Measure (in inches) the cabinet opening width. Always round down your measurements to the closest half inch.
- Now measure the length of your cabinet from front to back.
- Be sure to measure and inspect everywhere you're planning on installing a rolling shelf to avoid surprises. Remember, your pull-out shelf needs a clear path to extend. Hinges, doors, corners or other obstacles can get in the way, so you'll need to only consider the available gliding space.
- You are now ready to order your rolling shelves. When placing your order be sure to subtract 1" from the width. This considers the width of the steel rails, and to ensure the custom pull-out shelf fits comfortably in your cabinet

**Note:** Miracle Shelves come in three width-ranges: 1-16", 16-26", and 26-36". Length is available in the kitchen standard 22", and 18".

Watch this how to measure instructional video online at  
[www.miracleshelves.com/how-to/](http://www.miracleshelves.com/how-to/)

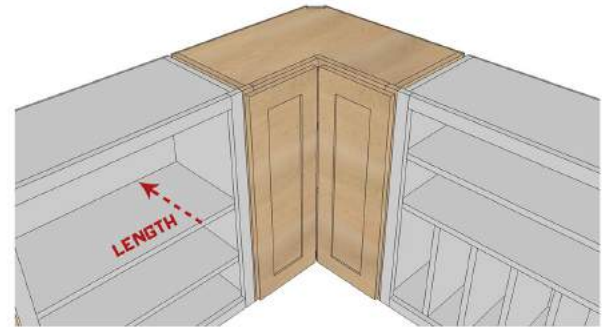
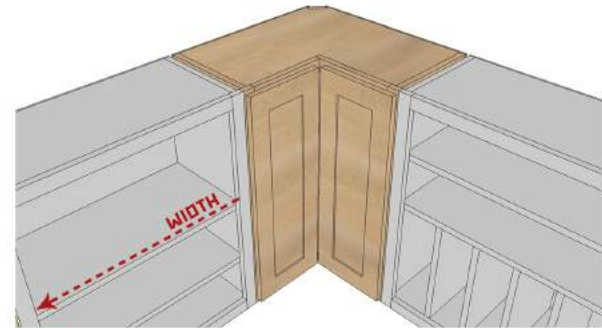

# Miracle Shelves<sup>®</sup>

## Assembling your pull-out shelf at home is easy

To get started, unpack your rails and custom rolling shelf and gather the necessary tools: wood glue, pencil, hammer and nails.

Miracle Shelves can be easily assembled using a regular hammer and finishing nails. \*An 18ga Brad nailer with compressor would also work.

*Note:* If you need to shorten the width of your shelf to fit your storage space, you will need to cut both width pieces and the shelf bottom with a circular saw or table saw: [www.miracleshelves.com/how-to/](http://www.miracleshelves.com/how-to/)

- Arrange pieces on a work bench or flat surface.
- Conservatively apply glue to all grooves on all four walls as well as the rabbeted edges. \*Rabbeted edges are the pieces with a groove cut into them.
- Place drawer bottom (white side down) in the groove of one of the rabbeted pieces. Keeping the drawer bottom vertical makes it easiest to assemble.
- Place the two side pieces in the rabbeted edges, then attach the last piece on top. Firmly squeeze the assembled unit together.
- Put two nails into each corner of the rabbeted pieces, either with a hammer or nailer. Wipe any excess glue off of the shelf.

### Attaching the Rails:

You will need a drill and the 1/2" wood screws to attach the rails to your shelves. \*a screw driver will also work.

- The rails are installed on the depth of your rolling shelves.
- Place the Miracle Shelf on it's side, and align the rail flush with the bottom of the shelf. This gives a space between the bottom of the shelf and the mounting bracket so the rail does not make contact with the screws or shelf bottom when sliding.
- Extend the rail while keeping it flush with the front of your shelf and put one screw in the first round hole.
- Extend the rail (still keeping it flush with the bottom) and place a screw in the last remaining screw.
- If you require more stability, install more screws in the holes provided to secure the rail to your shelf.

Watch this assembly instructional video online at  
[www.miracleshelves.com/how-to/](http://www.miracleshelves.com/how-to/)

## Installing your pull-out shelf with L-bracket instructions

If you are installing the pull-out shelf onto an upper adjustable shelf or one that's shaky, you will need to buy 4 L-brackets.

- Clear out the cabinet.
- Check to ensure the assembled shelf fits without any trouble.
- Make sure your existing cabinet shelf is level. If it is not level and not adjustable, shims will be required to level the rolling shelf brackets during installation.
- If your existing cabinet shelf is adjustable, it will need to be leveled and reinforced with 4 L-brackets. Place 2 L-brackets on the bottom front of either side of the shelf and 2 L-brackets on the back. This is to ensure up to 100 lbs capacity when the rails are fully extended.
- Now place your rolling shelf into the cabinet.
- Centre it side to side and front to back. The pull-out shelf should be flush with the front of the cabinet. If it goes past the edge of the cabinet, the door will hit it.
- Pull the shelf out towards you slowly so that both rails are exposed.
- Place a 1/2" screw in each rear bracket to hold them in place.
- Slowly test the pull-out shelf to make sure both rails stop at the same time.
- If there's a wobble, it means one rail is set in deeper than the other.
- Loosen the screw from that rail, adjust it, and re-test.
- Once the wobble is gone, mark each hole using a pencil. This will make it easier to position the brackets correctly if they shift while you work.
- Remove the rolling shelf by pressing on the side safety clippers. The one side clipper goes down while the other side goes up. Now you can clearly see the brackets and install the remaining screws.
- Once you are done screwing down the brackets, place the rolling shelf onto the rails and push back until you hear the click. Now the pull-out shelf is locked onto the rails.
- If you bought shelf bumpers, place them a 1/4" from the top of the rolling shelf on the side that the cabinet door is hung. The front lip should be tight to the corner. Ensure the edge of the door and the hinge will not be in the way for proper function.
- Drill slowly until the shelf bumper is snug.

Congratulations! Enjoy your Miracle Shelves!

Watch this installation instructional video online at  
[www.miracleshelves.com/how-to/](http://www.miracleshelves.com/how-to/)